

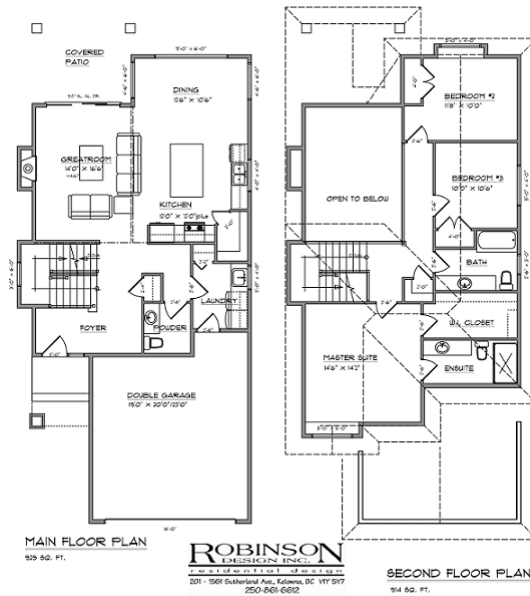

REAR ELEVATION

## The Scoria in Cornerstone Subdivision

1839 Sq./ft. 3 Bedroom, 2 1/2 bathroom with attached garage. This home offers an open great room with vaulted ceiling, a custom built kitchen with pantry and main floor laundry. You will also find 9' Main Floor Ceilings, Hardwood, Tile and Carpet. As well as a Gas Fireplace and high end finishing.



#5 450 Lakeshore Rd NE  
Box 716  
Salmon Arm BC, V1E 4N8  
P. 250.832.2567  
F. 250.832.5210  
whitstone.ca



**CHARACTER. CRAFTSMANSHIP. CREATIVITY**

# Cornerstone Subdivision

